



BOURBON LIBERTY 150 SERIES

Platform Supply vessels

DP2 - 1,701 t DWT

COMMITTED TO EXCELLENCE IN OPERATIONS

BOURBON's vision is to be the preferred company in offshore marine services for the benefit of our clients, our employees and all stakeholders.

► FOCUS ON OPERATIONAL EXCELLENCE

As a marine service provider leader, BOURBON operates a modern and fuel efficient fleet. With an industrial and centralized organization through 6 Repair Centers, vessels' reliability and availability is ensured. To help meet the highest safety standards, BOURBON systems are fully aligned with OCIMF standards and crews benefit of an active skills management process and training to provide tailor-made solutions to meet the demands of clients.

Fitted with standardized equipment, the BOURBON fleet offers to clients fuel efficient and safety solutions through:

- Diesel-electric propulsion
- Oil recovery, fire-fighting and stand-by rescue capabilities

► A CLIENT DEDICATED ORGANIZATION

BOURBON's "Client Satisfaction Chain" focuses on lasting relationship based on trust and service quality through a single point of contact: the Contracts Manager.



► A SERVICE DELIVERED BY LOCAL TALENTS

BOURBON relies on strong local partnerships and support to comply with local requirements and flagging. Local content is illustrated via:

➤ Vessels

Designed to be logistics friendly and suitable for local harbors.

➤ Collaborators

With 70% of local content and more than 83 nationalities, the Group focuses on local training through its 15 BOURBON Training Centers.

BOURBON LIBERTY 150 SERIES

Class

ABS❖A1, Offshore Support Vessel, Oil Recovery, Vessel Class 2 (OSR- S2), E, ❖AMS, ❖ACCU, ❖DPS-2, Fire-Fighting Vessel Class 1, ENVIRO, MLC-ACCOM

Series designed for customers from continental to deep offshore

MAIN PARTICULARS

	(US)	(Metric)
Designer	Shanghai Design Associates	
Builder	Sinopacific	
Lenght overall (ft/m)	202.7	61.8
Breadth moulded (ft/m)	45.9	14
Depth (ft/m)	19	5.8
Design Draft (ft/m)	14.1	4.3
Max. Draft (ft/m)	16.1	4.9
► Deadweight (st/mt) (approx.)	1,875	1,701
Gross tonnage (approx.)		1,740 gt

MACHINERY / PERFORMANCE

PROPULSION - MACHINERY

Main Diesel Generators (DG) engines	3 x 1,235 kW at 1,800 rpm 3Ph/480VAC/60 Hz
Propellers	2 x 843 kW L-drive FPP in nozzle, 360° azimuth thrusters 1 x 843 kW L-drive FPP in nozzle, fixed thrusters
Bow thrusters	2 x 560 kW FPP thrusters
Emergency generator / dedicated harbor generator	1 x 276 kW

SPEED CONSUMPTION

Maximum speed - 12.3 knots	17.1 t/day
Service speed - 12 knots	15.8 t/day
Service speed - 10 knots	9.0 t/day
Eco speed - 8 knots	5.8 t/day
DP Station keeping	4.5 t/day
Standby at sea	2.4 t/day
Standby in port - Harbour generator	0.7 t/day
(Speed and consumption at 4.30 m design draft, clean hull, calm sea, no sea margin)	

COMBINED CAPACITIES (100%)

	(US)	(Metric)
► Free cargo deck area (sq.ft/m²)	4,306	400
Deck load (st/mt)	727	660
Fuel Oil (USG/m³)	161,409	611
Fresh water (USG/m³)	94,837	359
Ballast/Drill water (USG/m³)	160,088	606
► Liquid Products Tanks (USG/m³)	178,580	676
Dry Bulk/ Cement (USG/m³)	40,863	180
Foam (USG/m³)	4,755	18

DELIVERY RATES

Fuel oil	(US)	2 x 660 USG/min at 7 bars
	(Metric)	2 x 150 m³/h at 70 m
Fresh water	(US)	660 USG/min at 7 bars
	(Metric)	150 m³/h at 70 m
Drill water / Ballast	(US)	660 USG/min at 7 bars
	(Metric)	150 m³/h at 70 m
Dry bulk (compressor flow)	(US)	2 x 97 USG/min at 6 bars
	(Metric)	2 x 22 m³/min at 60 m
Liquid mud	(US)	2 x 330 USG/min at 18 bars
	(Metric)	2 x 75 m³/h at 180 m
Liquid mud and special product tanks fitted with hydraulic agitators and fixed hot water washing system		

ACCOMMODATIONS

- Accommodations **24 pers.**
- Single cabins **4**
- 2 x men cabins **10**
- Mess room (1), Day rooms (2), Galley (1), Office (1), Hospital/Sick Bay (1 Berth)
- Fully air-conditioned

EQUIPMENT & ELECTRONICS

DECK EQUIPMENT

	(US)	(Metric)
Windlass (lt/mt)	1 x 6.5	1 x 6.6
Tugger winches (lt/mt)	1 x 9.8	1 x 10
Capstan (lt/mt)	2 x 4.9	2 x 5
Deck Provision Crane [lt/mt] x 1 at [ft/m]	3 52.5	3 16

DYNAMIC POSITIONING SYSTEM

- DP Class 2
- System consists of 2 DGPS, 1 Radscan

COMMUNICATION

1 radio system compliant with GMDSS A3 rules
Vsat, FBB500, Inmarsat C
Email/IP voice facilities

SAFETY EQUIPMENT

- Fire-fighting Class 1 (FIFI1) with foam and waterspray protection
- Pumps [USG/min-m³/h] x 2 7,265 (each) 1,650 (each)
- Monitors [USG/min-m³/h] x 2 5,283 (each) 1,200 (each)

LIFE SAVING ARRANGEMENT

Vessel fitted with safety equipment according to SOLAS Regulation
1 Fast Rescue Boat (for 10 persons) with davit
6 Life rafts (3 on each side), each life raft is able to accommodate 12 persons
Life jackets, life buoys, immersion suits

DP CAPABILITY PLOT

Tremendous station keeping capability
Safer operations
Increased operational time
Exceptional maneuverability in adverse weather conditions

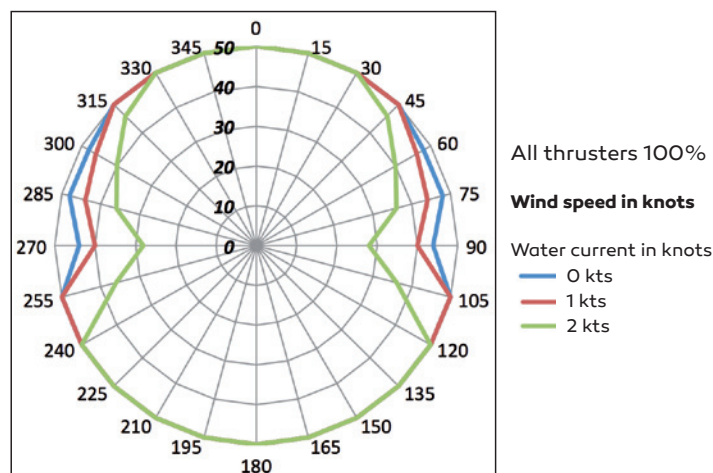

All particulars believed to be correct but not guaranteed

DIFFERENTIATING FACTORS

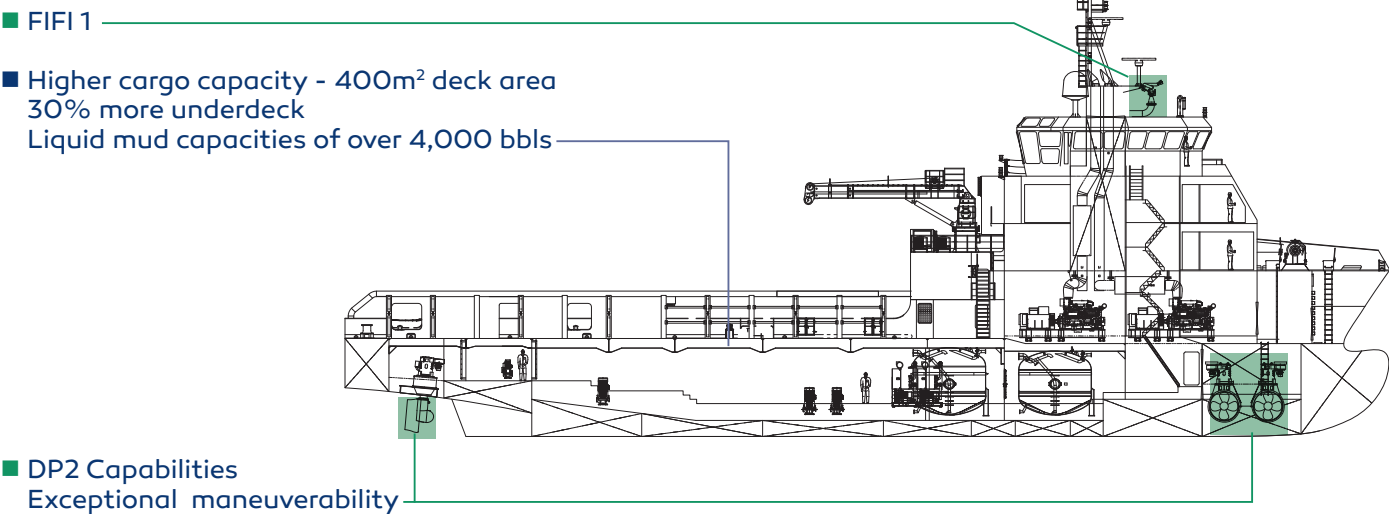

BOURBON'S EFFICIENT FUEL MANAGEMENT

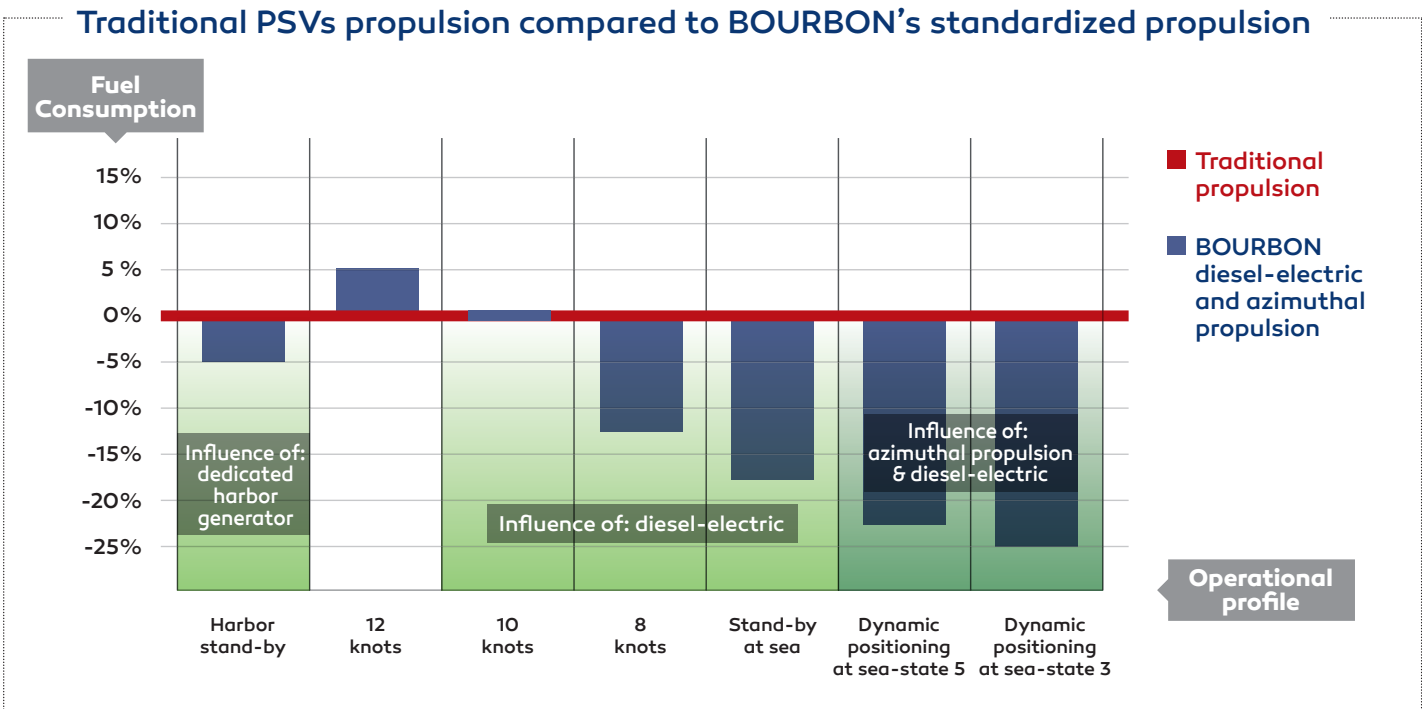

Total amount of cargo vessel is able to carry is equivalent to the deadweight of vessel

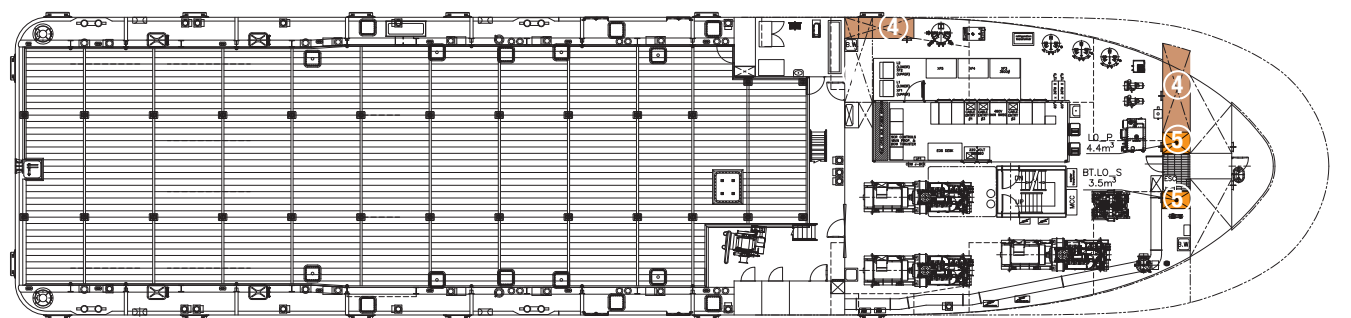

MAIN DECK

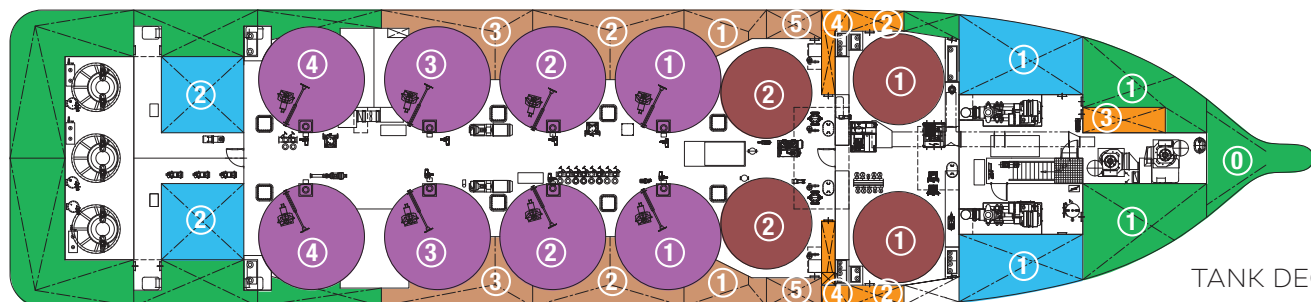

TANK DECK

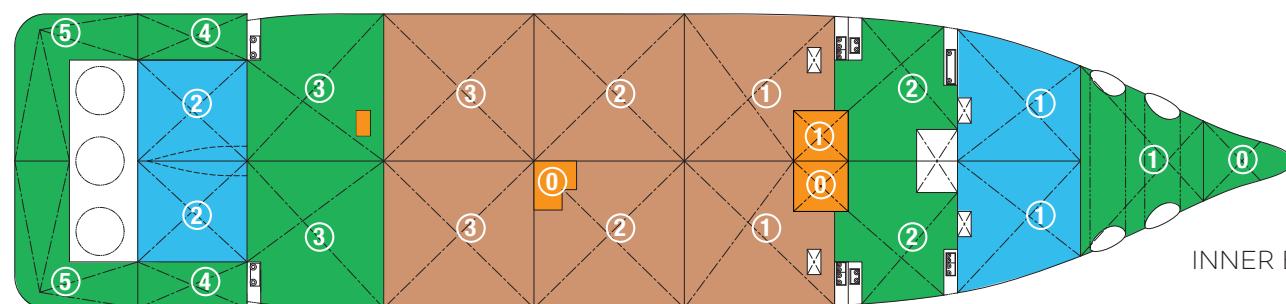

INNER BOTTOM

OUTSTANDING TANKS CAPACITIES

(C) center, (P) portside, (S) starboard

BALLAST WATER TANKS			FRESH WATER TANKS			LIQUID PRODUCT TANKS		
100% CAPACITIES			100% CAPACITIES			100% CAPACITIES		
0	Water Ballast Forepeak (C)	51.26 m ³	1	Fresh Water (P)	117.75 m ³	1	Liquid Product (P)	88.97 m ³
1	Water Ballast /Drill Water (C)	38.25 m ³	1	Fresh Water (S)	106.40 m ³	1	Liquid Product (S)	88.97 m ³
1	Water Ballast /Drill Water (P)	42.66 m ³	2	Fresh Water (P)	67.31 m ³	2	Liquid Product (P)	88.97 m ³
1	Water Ballast /Drill Water (S)	53.67 m ³	2	Fresh Water (S)	67.31 m ³	2	Liquid Product (S)	88.97 m ³
2	Water Ballast /Drill Water (P)	38.11 m ³				3	Liquid Product (P)	86.92 m ³
2	Water Ballast /Drill Water (S)	39.81 m ³				3	Liquid Product (S)	86.92 m ³
3	Water Ballast /Drill Water (P)	69.04 m ³				4	Liquid Product (P)	72.93 m ³
3	Water Ballast /Drill Water (S)	69.94 m ³				4	Liquid Product (S)	72.93 m ³
4	Water Ballast /Drill Water (P)	35.80 m ³				8 Liquid Product Tanks (mud, brine, base oil, oil recovery, drill water)		
4	Water Ballast /Drill Water (S)	35.80 m ³						
5	Water Ballast (P)	65.16 m ³						
5	Water Ballast (S)	65.16 m ³						
TOTAL = 605.56 m ³			TOTAL = 358.77 m ³			TOTAL = 675.58 m ³		

FUEL OIL TANKS			DRY BULK TANKS			MISCELLANEOUS TANKS		
100% CAPACITIES			100% CAPACITIES			100% CAPACITIES		
1	Fuel Oil (P)	71.91 m ³	1	Dry Bulk (S)	43.68 m ³	0	Oily Water 1	6.00 m ³
1	Fuel Oil (S)	68.07 m ³	1	Dry Bulk (P)	43.68 m ³	0	Oily Water 2	3.85 m ³
2	Fuel Oil (P)	94.82 m ³	2	Dry Bulk (S)	46.41 m ³	1	Sludge	6.00 m ³
2	Fuel Oil (S)	94.82 m ³	2	Dry Bulk (P)	46.41 m ³	2	Foam (P)	8.78 m ³
3	Fuel Oil (P)	110.65 m ³				2	Foam (S)	8.78 m ³
3	Fuel Oil (S)	110.65 m ³				3	Sewage	11.01 m ³
4	Fuel Oil Day (P)	15.64 m ³				4	Fuel Oil Overflow (P)	13.89 m ³
4	Fuel Oil Day (P)	11.15 m ³				4	Fuel Oil Overflow (S)	13.59 m ³
5	Fuel Oil Settling (P)	15.10 m ³				5	Lub Oil	5.35 m ³
5	Fuel Oil Settling (S)	15.10 m ³				5	Lub Oil BT	3.57 m ³
6	Fuel Oil Emergency Generator	3.18 m ³						
TOTAL = 611.09 m ³			TOTAL = 180.18 m ³			TOTAL = 80.82 m ³		

Total amount of cargo vessel is able to carry is equivalent to the deadweight of vessel



Contact:
marketing@bourbon-marine-services.com

BOURBONOFFSHORE.COM

BOURBON
Building together a sea of trust