



# 181' BOURBON DENEb

DP1 Fast support and intervention vessel (FSIV)

36 passengers

390 Metric ton deck cargo



181' BOURBON DENEb has been designed by Sea Craft Design Inc. for fast transportation of personnel and cargo.

Able to carry 390 metric tons on deck at 15 knots, this vessel allows crew changes on distant deep water fields and urgent cargo shipments.

Under the main deck, the vessel is fitted with fuel, fresh water cargo capacities and four methanol tanks.

The propulsion with four propellers and a bow thruster gives her an excellent manoeuvrability. It is classed DP1.

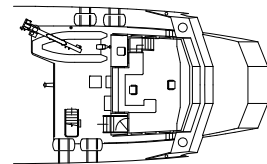

UPPER DECK

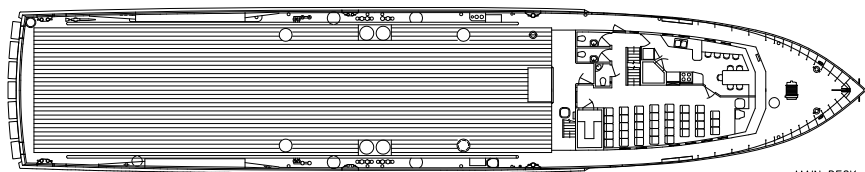

MAIN DECK

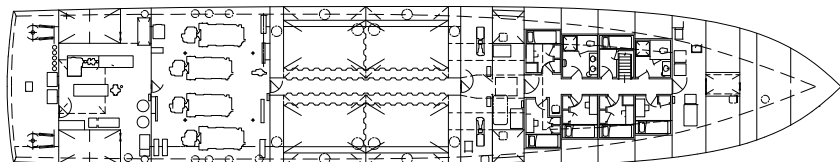

HULL PLAN

« Photo: «BOURBON PROCYON» Sistership of «BOURBON DENEb».

## REGISTRATION

Vessel Name: **BOURBON DENEb**  
Type: **type "FSH" (fully shaped hull)**.  
Year: **2008**  
Owner: **Bourbon Offshore**

Builder: **C & G Boatworks, Inc.**  
Class: **ABS +A1 +AMS, DPS 1, HSC Crewboat notation, USCG Subchapter L, ABS International load line.**  
Flag: **VANUATU**

Updated: 13-07-2009



# TECHNICAL SPECIFICATIONS

## FSIV - 181' BOURBON DENEBO



### MAIN PARTICULARS

#### DIMENSIONS

Length overall:.....55,15 m  
 Breadth moulded:.....10,37 m  
 Depth:.....4,23 m  
 Draft:.....3.75 m  
 Deadweight:.....580 mt  
 Gross tonnage:.....< 500

#### CAPACITIES

Deck area:..... (34,50 x 8,60) 248 m2 @ 2,5 mt/m2  
 Deck cargo:.....390 t  
 Fuel oil:.....136 m3  
 Liquid mud or methanol:(4 tanks).....119 m3  
 Drill water:.....102 m3  
 Fresh water:.....11.70 m3  
 Gray water:.....3.5 m3  
 Bilge:.....3.5 m3  
 Sewage:.....1.60 m3  
 Lub oil:.....2.10 m3

#### DELIVERY RATES

Fuel oil:.....60 m3/h at 6 bars  
 Drill water:.....60 m3/h at 6 bars  
 Liquid mud:.....100 m3/h at 6 bars  
 2 independent pumping systems high mixers.  
 Methanol : .....60 m3 at 3.8 bars  
 - 1 independent methanol pumping system.  
 Bulk: 1 compressor rated .....96 m3 at 5 bars

#### ACCOMMODATIONS

Accommodations for:.....10 pers  
 1 man cabins:.....2  
 2 man cabins:.....4  
 Mess / Day rooms, Laundry, Galley, stores,  
 Fully air conditioned.  
  
 Fitted with 36 individual seats in 1 lounge.

### MACHINERY / PERFORMANCE

#### PROPULSION - MACHINERY

Main engines:.....4 x 1,800 Bhp (total=7,200 Bhp).  
 Propellers:.....4 x 54" diameter with 4 blades 56" pitch.  
 Bow Retractable thruster:.....250 Bhp  
 Auxiliary generators:.....2 x 160 KW  
 1 fuel oil purifier.

#### SPEED / CONSUMPTION

Maximum speed (100%):.....18.2 m3/day 23 knots  
 Full loaded speed : .....22.7 m3/day 15 knots

### EQUIPMENT & ELECTRONICS

#### DECK EQUIPMENT

Anchor windlass: (1x195 kg anchor).....1  
 Fire-fighting:  
 1 monitor (270 m3/h) and 1 pump (270 m3/h).  
 Roll reduction System

#### SAFETY EQUIPMENT

Life saving arrangement  
 Stand by rescue equipment  
 1 MOB boat with davit SOLAS.

#### DYNAMIC POSITIONING SYSTEM

Type:.....Class 1  
 -Sensors and monitoring as per class 1 requirements.

#### ELECTRONICS

##### - NAVIGATION

2 radars  
 1 gyrocompass  
 1 magnetic compass  
 1 digital echo-sounder  
 1 speed log  
 1 autopilot system  
 1 GPS  
 1 Navtex

##### - COMMUNICATION

1 radio system compliant with GMDSS A3  
 1 SSB Duplex DSC  
 2 INMARSAT (C and F55)  
 2 VHF  
 EPIRB

*All particulars believed to be correct but not guaranteed*

**Bourbon Offshore** - 148, rue Sainte - 13007 Marseille - France  
 Internet: [www.bourbon-online.com](http://www.bourbon-online.com) - E-mail: [bourbon-offshore@bourbon-online.com](mailto:bourbon-offshore@bourbon-online.com)